



FLDL-SG1

STORM PRO™ Fire-Rated Fusible Link Louver

PRODUCT CUT SHEET

PROJECT:
SUBMITTED BY:
DATE:
NOTES:

For 1 3/4" Thick Doors Up To 90 Minutes

- Blades Close When Activated By Fire/Heat
- 18 Ga. Cold Rolled Steel Frame
- 18 Ga. Cold Rolled Steel Adjustable "Z" Blades
- 12 Ga. Cold Rolled Steel Security Grille One Side
- Mitered Corners Secured With Reinforcing Clips
- Stainless Steel Spring
- 165° Fusible Link
- #8 X 1" One Way Vandal Resistant Screws
- Free Area 40%
- Gray Primer (GPZ) Powder Coat Finish

Available Options

- Powder Coat Color Options - See Color Chart on www.ngp.com
- Aluminum Insect Screen - 22 Ga. 1/8" Square Mesh Installed on Exterior Side
- Torx Security Screws
- Galvanneal - A40 Steel Frame and Blades (Security Grille not Available in Galvanneal)
- Type 304 Stainless Steel - Specify FLDL-SG1-SS
- Type 316 Stainless Steel - Specify FLDL-SG1-316SS

Size Information:

Available in Whole Inch Increments
Minimum size: 10" x 6", Maximum size: 24" x 30"

Windstorm Rated

- Louver for Use in Windstorm-Rated Assembly in Accordance with ANSI/ASTM E330, ANSI/ASTM E1886, ASTM E1996, AAMA/WDMA/CSA 101/I.S.2/A440, FEMA 320, FEMA 361 and ICC 500.
Design Pressure = +/- 70 PSF
Large Missile Impact = 350 ft. lbs.
Hazard - Hurricane
- Maximum Size for Hurricane Use is 24" x 24" (610mm x 610mm)

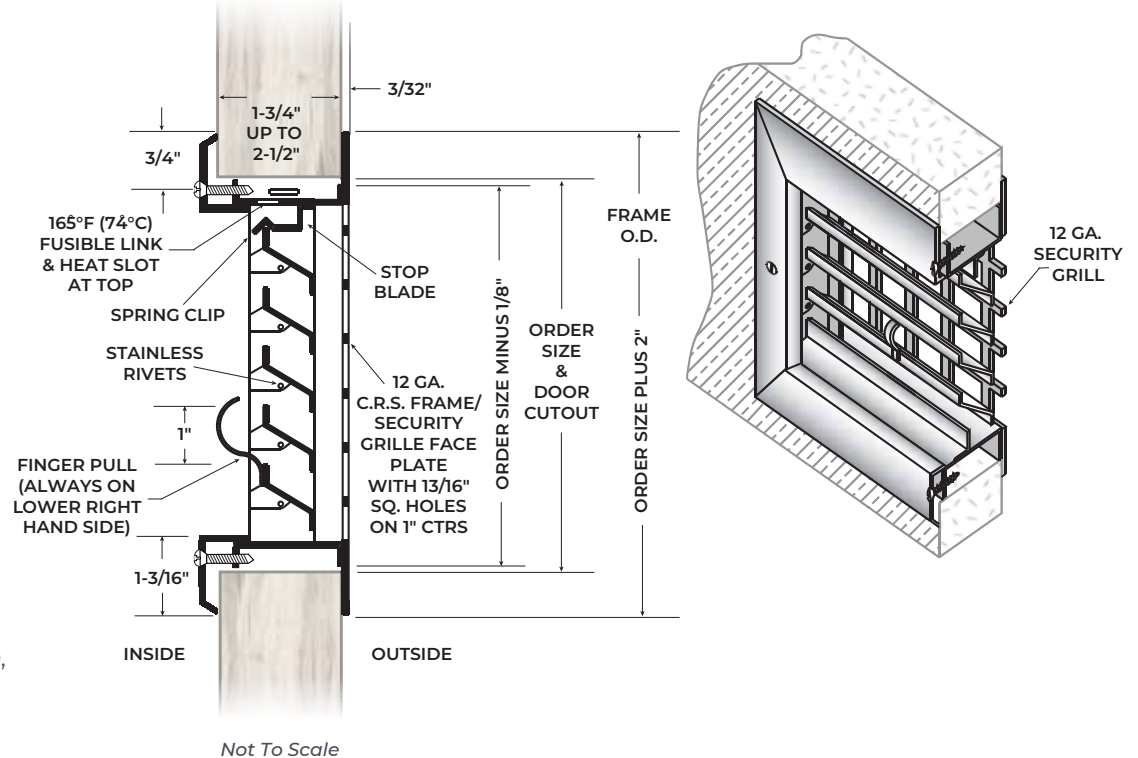

NGP MEMPHIS
4985 East Raines Road
Memphis, TN 38118
orders@ngp.com

NGP VEGAS
4584 Calimesa Street
Las Vegas, NV 89115
vegasorders@ngp.com

NGP-LIT-FLDL-SG1-PCS-0123-A

ngp.com
1-800-NGP-RUSH