



# AFDL-SS, AFDL-T-SS

Stainless Steel No Vision Door Louver

## PRODUCT CUT SHEET

PROJECT:
SUBMITTED BY:
DATE:
NOTES:

### For 1 3/4" Thick Doors

- 18 Ga. Type 304 Stainless Steel Frame
- Mitered and Welded Corners
- Inverted "Y" Design
- Blades 22 Ga. Type 304 Stainless Steel
- Counter-Sunk Mounting Screw-Holes
- #8 X 1" Phillips Head SMS
- Available in Uneven and Fractional Sizes
- Free Area 50%
- #4 Satin Finish

#### Available Options

- Type 316 Stainless Steel – Specify AFDL-316SS, AFDL-T-316SS
- Aluminum Insect Screen - 22 Ga. 1/8" Square Mesh Installed on Exterior Side Unless Requested Otherwise
- Torx Security Screws

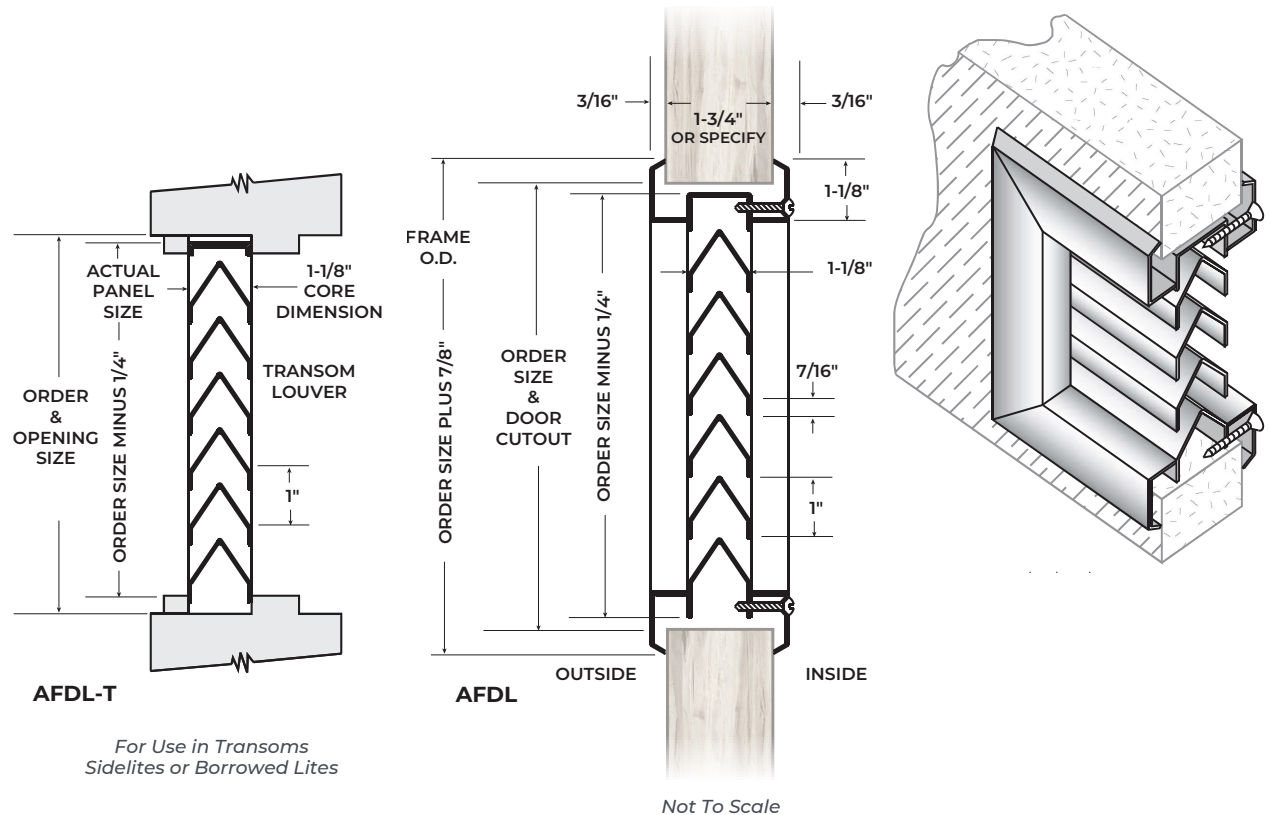

NGP-LIT-AFDL-SS\_AFDL-T-SS-PCS-1022-A

**NGP MEMPHIS**  
 4985 East Raines Road  
 Memphis, TN 38118  
[orders@ngp.com](mailto:orders@ngp.com)

**NGP VEGAS**  
 4584 Calimesa Street  
 Las Vegas, NV 89115  
[vegasorders@ngp.com](mailto:vegasorders@ngp.com)

**ngp.com**  
 1-800-NGP-RUSH