



# 36ET

Thermoplastic Door Shoe

## PRODUCT CUT SHEET

PROJECT:
SUBMITTED BY:
DATE:
NOTES:

### Material

Aluminum Alloy 6063, T5 Temper  
Thermoplastic Polymer: Polyvinyl Chloride (PVC) Formulated with an Environmentally Friendly Bio-Based Plasticizer  
Seal with Rigid Base and Soft Vinyl Fins is Dark Brown

- ▶ Economical
- ▶ Flame resistant
- ▶ Moisture Resistant
- ▶ Temperature Range 0°F to 140°F
- ▶ Oxidative Degradation From Age and Exposure to Cold, Heat and UV Causes Hardening, Loss of Memory and Resilience, Cracking, Crazeing and Discoloration
- ▶ #6 x 3/4" Stainless Steel Sheet Metal Screws Furnished
- ▶ 48" Maximum Length

### Finishes

36ET Mill Aluminum  
36ETDKB Dark Bronze

### Options

Notched Fins - Suffix "NF"

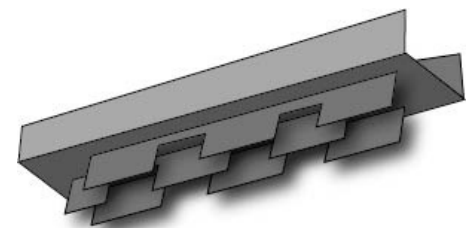
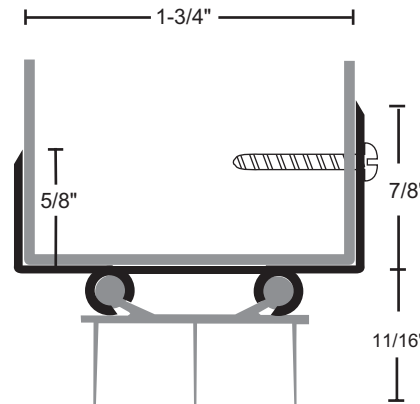

Optional: Notched Fins - Suffix "NF"  
Allows air flow while restricting light



NGP-GKT-36ET-PCS-1220-A